

1 UNIT C SECOND FLOOR SPECIAL SYSTEMS PLAN
SCALE: 1/8" = 1'-0"

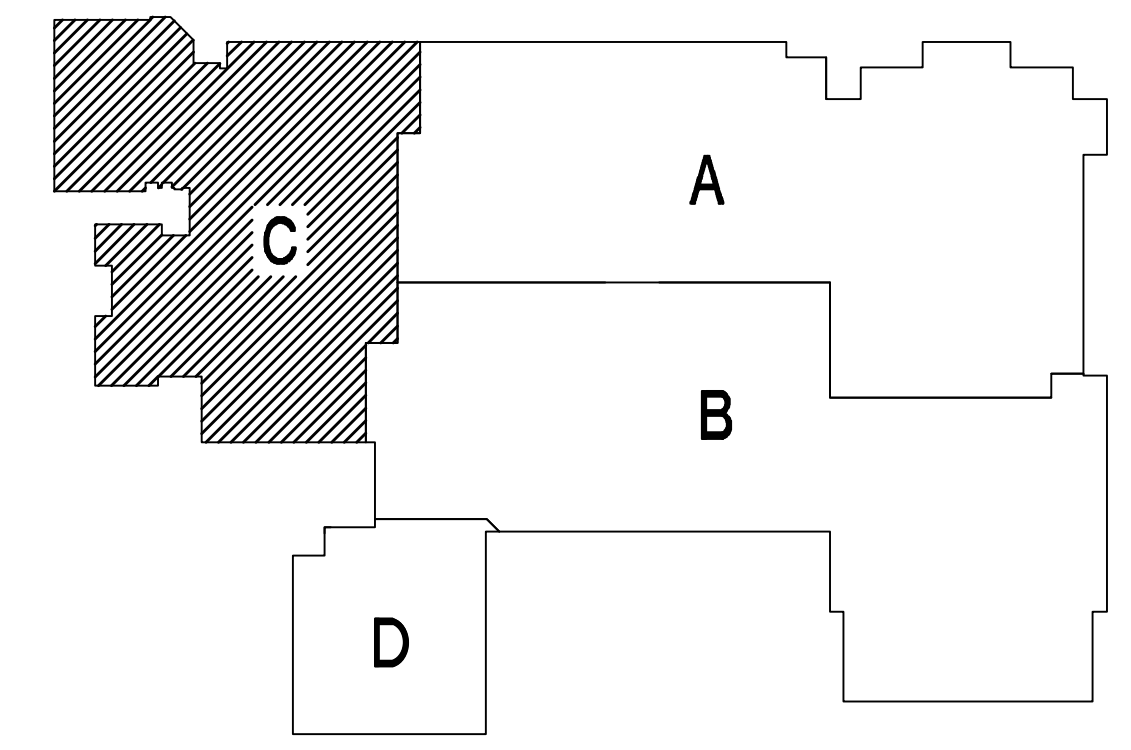
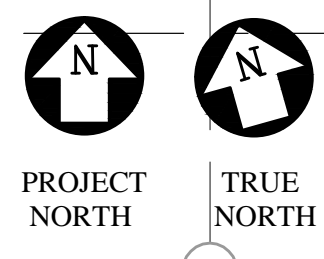

KEY PLAN

SPECIFIC NOTES:

- 1 PROVIDE AN 18 INCH WIDE x 2" HIGH WIRE MESH, CABLE TRAY, MOUNT ABOVE ACCESSIBLE CEILINGS. SEE THE CABLE TRAY SPECIFICATION SECTION FOR FURTHER DETAILS.
- 2 PROVIDE A 24 INCH WIDE x 3" HIGH CABLE TRAY.
- 3 FIRE STOP ALL CONDUIT SLEEVES PENETRATING THE FIRE-RATED WALLS.
- 4 JUNCTION BOX #1--PROVIDE A 12"x8"x4" DEEP NEMA 1 JUNCTION WITH A HINGED COVER. MOUNT THE BOX ABOVE THE ACCESSIBLE LAY-IN CEILING. SEE THE CLASSROOM ROUGH-IN CABLING DETAIL ON SHEET E0.7 FOR SYSTEM DETAILS.
- 5 CLASSROOM JUNCTION BOX #2--PROVIDE A 4 INCH SQUARE BOX AND MOUNT ABOVE THE ACCESSIBLE LAY-IN CEILING. SEE THE CLASSROOM ROUGH-IN CABLING DETAIL ON SHEET E0.7 FOR SYSTEM DETAILS.
- 6 CLASSROOM JUNCTION BOX #3--PROVIDE A 4 INCH SQUARE BOX AND MOUNT ABOVE THE ACCESSIBLE LAY-IN CEILING. SEE THE CLASSROOM ROUGH-IN CABLING DETAIL ON SHEET E0.7 FOR SYSTEM DETAILS.
- 7 CLASSROOM JUNCTION BOX #4--PROVIDE A 4 INCH SQUARE BOX AND MOUNT ADJACENT TO THE TEACHER WORKSTATION @ 16" AFF. SEE THE CLASSROOM ROUGH-IN CABLING DETAIL ON SHEET E0.7 FOR SYSTEM DETAILS.
- 8 CLASSROOM JUNCTION BOX #5--PROVIDE A 4 INCH SQUARE BOX AND MOUNT AT 90° AFF. SEE THE CLASSROOM ROUGH-IN CABLING DETAIL ON SHEET E0.7 FOR SYSTEM DETAILS.
- 9 CLASSROOM JUNCTION BOX #6--PROVIDE A 4 INCH SQUARE BOX AND MOUNT AT 90° AFF. SEE THE CLASSROOM ROUGH-IN CABLING DETAIL ON SHEET E0.7 FOR SYSTEM DETAILS.
- 10 CLASSROOM JUNCTION BOX #7--PROVIDE A 4 INCH SQUARE BOX AND MOUNT AT 90° AFF. SEE THE CLASSROOM ROUGH-IN CABLING DETAIL ON SHEET E0.7 FOR SYSTEM DETAILS.
- 11 CLASSROOM JUNCTION BOX #8--PROVIDE A 4" SQUARE BOX AND MOUNT AT 16" AFF. SEE THE CLASSROOM ROUGH-IN CABLING DETAIL ON SHEET E0.7 FOR SYSTEM DETAILS.
- 12 CLASSROOM JUNCTION BOX #9--PROVIDE A 4" SQUARE BOX AND MOUNT AT 16" AFF. SEE THE CLASSROOM ROUGH-IN CABLING DETAIL ON SHEET E0.7 FOR SYSTEM DETAILS.
- 13 CLASSROOM JUNCTION BOX #10--PROVIDE A 4" SQUARE BOX AND MOUNT AT 16" AFF. SEE THE CLASSROOM ROUGH-IN CABLING DETAIL ON SHEET E0.7 FOR SYSTEM DETAILS. MOUNT ADJACENT TO THE TEACHER'S WORKSTATION.
- 14 PROVIDE DATA PLUG-IN RACEWAY, STARLINE#SBD SERIES OR APPROVED EQUAL.
- 15 PROVIDE (1) CAT 5E CABLE IN 3/4" CONDUIT FOR CONNECTION TO THE ELEVATOR CONTROLLER. FINAL CONNECTIONS TO BE PERFORMED BY THE ELEVATOR CONTRACTOR.
- 16 NOT USED.
- 17 PROVIDE (6) EMPTY 4" EMPTY CONDUITS WITH PULLCORDS FOR THE TELEPHONE, WAN AND MATV SYSTEM.
- 18 PROVIDE A 4" SQUARE JUNCTION BOX FLUSH WITH ACCESSIBLE CEILING FOR THE PROJECTOR. VERIFY EXACT LOCATION PRIOR TO ROUGH-IN.
- 19 SEE VOICE/DATA CABLE SCHEDULE ON SHEET E6.08 FOR ADDITIONAL DETAILS.
- 20 PROVIDE (1) CCTV SIGNAL CABLE 3/4" CONDUIT TO THE BUILDING CABLE TRAY. EXTEND THE CABLE TO THE CCTV CONTROLLER LOCATED IN MAIN COMM. ROOM 134.
- 21 PROVIDE (4) EMPTY CONDUITS WITH PULL CORDS.
- 22 DATA OUTLET FOR CONNECTION TO THE SMART BOARD. VERIFY THE MOUNTING HEIGHT PER THE ARCHITECTURAL DETAILS PRIOR TO ROUGH-IN.

REVISIONS	BY
06-22-10	ADG
07-12-10	ADG

CONTRACTOR MUST VERIFY AND CHECK ALL JOB DIMENSIONS, REVISE AND SPECIFY BEFORE PROCEEDING TO SITE AND REPORT ANY ERRORS, OMISSIONS AND DISCREPANCIES BEFORE PROCEEDING.

NEW PHOENIX PRE-K THROUGH 12 SCHOOL

UNIT C SECOND FLOOR SPECIAL SYSTEMS PLAN

DRAWN: JAM
CHECKED: RAG
SCALE:
DATE: 05-24-2010

